

# MET CAMPUS - PATIENT VISITOR WAYFINDING MAP & DIRECTORY (GROUND LEVEL)

EMERGENCY  
ROOM ENTRANCE

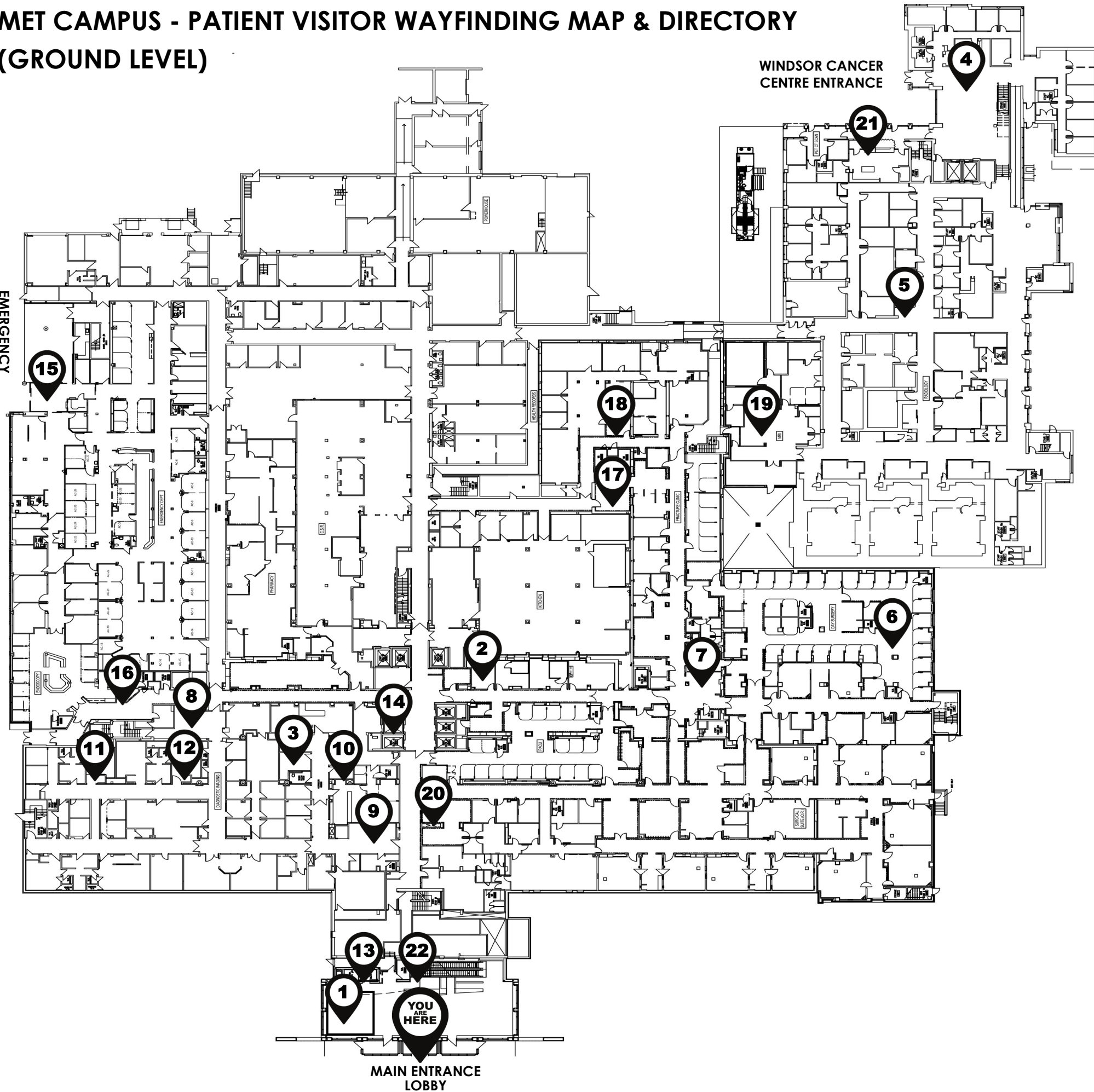

## DIRECTORY (please see step-by-step directions on reverse)

- 1 - Admitting
- 2 - Audiology
- 3 - Bone Density Test / Scan
- 4 - Cancer Centre
- 5 - Cancer Centre Lab
- 6 - Cysto / Urology Clinic
- 7 - Day Surgery
- 8 - Diagnostic Imaging - Registration
- 9 - Diagnostic Imaging - CT Scan
- 10 - Diagnostic Imaging - Nuclear Medicine
- 11 - Diagnostic Imaging - Ultrasound
- 12 - Diagnostic Imaging - X-Ray
- 13 - Elevators (Main Lobby)
- 14 - Elevators (Patients/Visitors)
- 15 - Emergency Department
- 16 - Endoscopy (Colonoscopy/Gastroscopy)
- 17 - Fracture Clinic
- 18 - Health Records
- 19 - MRI
- 20 - Operating Room (Waiting Area)
- 21 - Pharmacy
- 22 - Security

# MET CAMPUS - PATIENT VISITOR WAYFINDING - STEP-BY-STEP DIRECTIONS

## (GROUND LEVEL)

|    |  |   |
|----|--|---|
| 1  | <b>Admitting</b>                                 | Lower lobby entrance, proceed to Admitting on left side of lobby  |
| 2  | <b>Audiology</b>                                 | Lower lobby entrance, proceed to Admitting on left side of lobby, then proceed to hallway by elevators, proceed down hallway just past elevators, turn right, down hallway to Audiology.                            |
| 3  | <b>Bone Density Test / Scan</b>                  | Lower lobby entrance, proceed to hallway by elevators, turn right and follow signage past elevators, turn left to Diagnostic Imaging - Registration.  |
| 4  | <b>Cancer Centre</b>                             | Lower lobby entrance, proceed to Admitting on left side of lobby, then proceed to hallway by elevators, follow signage past second elevators to end of hallway, turn right and follow signage to Cancer Centre.     |
| 5  | <b>Cancer Centre Lab</b>                         | Lower lobby entrance, proceed to Admitting on left side of lobby, then proceed to hallway by elevators, follow signage past second elevators to end of hallway, turn right and follow signage to Cancer Centre Lab. |
| 6  | <b>Cysto / Urology Clinic</b>                    | Lower lobby entrance, proceed to Admitting on left side of lobby, then proceed to hallway by elevators, proceed down hallway just past elevators and see signage for Cysto Clinic.                                  |
| 7  | <b>Day Surgery</b>                               | Lower lobby entrance, proceed to Admitting on left side of lobby, then proceed to hallway by elevators, proceed down hallway just past elevators and see signage for Day Surgery.                                   |
| 8  | <b>Diagnostic Imaging - Registration</b>         | Lower lobby entrance, proceed to hallway by elevators, turn right and follow signage past elevators, turn left to Diagnostic Imaging - Registration.  |
| 9  | <b>Diagnostic Imaging - CT Scan</b>              | Lower lobby entrance, proceed to hallway by elevators, turn right and follow signage past elevators, turn left to Diagnostic Imaging - Registration.  |
| 10 | <b>Diagnostic Imaging - Nuclear Medicine</b>     | Lower lobby entrance, proceed to hallway by elevators, turn right and follow signage past elevators, turn left to Diagnostic Imaging - Registration.  |
| 11 | <b>Diagnostic Imaging - Ultrasound</b>           | Lower lobby entrance, proceed to hallway by elevators, turn right and follow signage past elevators, turn left to Diagnostic Imaging - Registration.  |
| 12 | <b>Diagnostic Imaging—X-Ray</b>                  | Lower lobby entrance, proceed to hallway by elevators, turn right and follow signage past elevators, turn left to Diagnostic Imaging - Registration.  |
| 13 | <b>Elevators (Ground Lobby)</b>                  | Lower lobby entrance, proceed to left side of lobby to elevators.   |
| 14 | <b>Elevators (Patient/Visitors) Floors 1 - 8</b> | Lower lobby entrance, proceed to hallway by elevators, turn right, proceed down hallway to Elevators on right.  |
| 15 | <b>Emergency Department</b>                      | Proceed back outside of Main Entrance, turn right and proceed around the building, turn right and proceed to the Emergency Department.  |
| 16 | <b>Endoscopy (Colonscopy/Gastroscopy)</b>        | Lower lobby entrance, proceed to Admitting on left side of lobby, then proceed to hallway by elevators, proceed down hallway just past elevators and see signage for Endoscopy.                                     |
| 17 | <b>Fracture Clinic</b>                           | Lower lobby entrance, proceed to Admitting on left side of lobby, then proceed to hallway by elevators, proceed down hallway following purple coloured line to Fracture Clinic.                                     |
| 18 | <b>Health Records</b>                            | Lower lobby entrance, proceed to Admitting on left side of lobby, then proceed to hallway by elevators, proceed down hallwaysecond elevators following teal coloured line for Health Records signage.               |
| 19 | <b>MRI</b>                                       | Lower lobby entrance, proceed to Admitting on left side of lobby, then proceed to hallway by elevators, proceed down hallwaysecond elevators following teal coloured line for MRI signage.                          |
| 20 | <b>Operating Room (Waiting Area)</b>             | Lower lobby entrance, proceed to Admitting on left side of lobby, then proceed down hallway and see signage for Operating Room Waiting Area on right.   |
| 21 | <b>Pharmacy</b>                                  | Lower lobby entrance, proceed to Admitting on left side of lobby, then proceed to hallway by elevators, follow signage past second elevators to end of hallway, turn right and follow signage to Pharmacy.          |
| 22 | <b>Security</b>                                  | Lower lobby entrance, proceed forward to security desk  |

# MET CAMPUS - PATIENT VISITOR WAYFINDING MAP & DIRECTORY (FLOOR LEVEL 1)

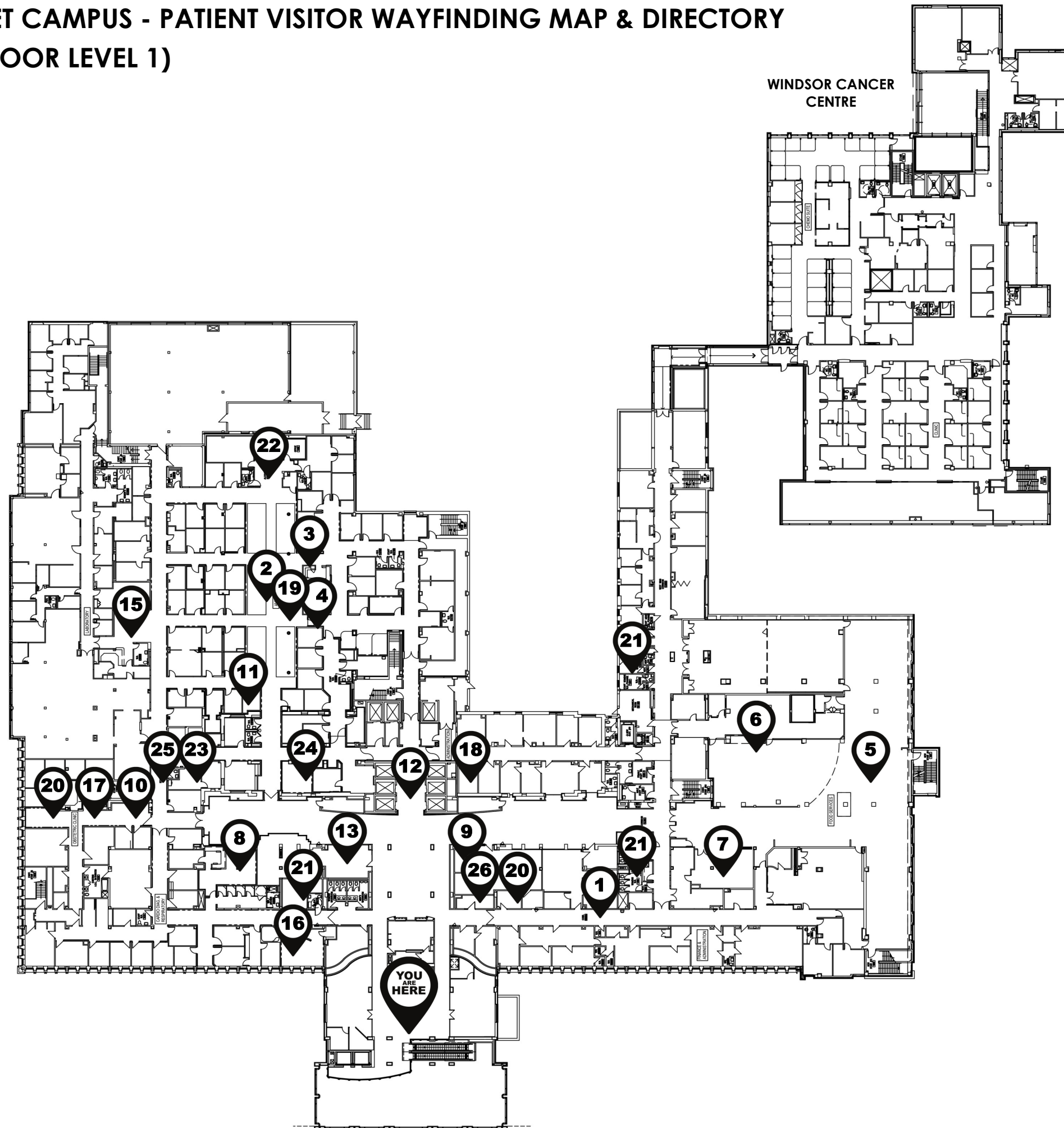

## DIRECTORY (please see step-by-step directions on reverse)

- 1 - Administration
- 2 - Ambulatory Care
- 3 - Breast Health Centre / Mammograms
- 4 - Burns & Plastics Clinic
- 5 - Cafeteria
- 6 - Daily Grill / Subway
- 7 - Tim Hortons
- 8 - Cardiopulmonary
- 9 - Cashiers
- 10 - Community Care Access Centre (CCAC)
- 11 - Diabetic Clinic
- 12 - Elevators (Patient/Visitors): Floors 1 - 8
- 13 - Gift Shop
- 14 - Gynecology Clinic
- 15 - Laboratory
- 16 - Multi-Faith Prayer Room
- 17 - OB Clinic
- 18 - Patient Representative
- 19 - Pre-Admission Clinic
- 20 - Public Affairs & Communications
- 21 - Public Washrooms
- 22 - Rapid Assessment Clinic
- 23 - Student Registration
- 24 - Telemedicine
- 25 - Volunteer Services
- 26 - Windsor Regional Hospital Foundation

# MET CAMPUS - PATIENT VISITOR WAYFINDING - STEP-BY-STEP DIRECTIONS

## (FLOOR LEVEL 1)

|    |  |  |
|----|--|--|
| 1  | Administration                             | Lower lobby entrance, proceed to elevator or escalator to 1ST Floor, proceed to First Floor lobby, turn right, proceed down hallway to Administration.   |
| 2  | Ambulatory Care                            | Lobby entrance, proceed to Admitting, proceed to elevator or stairs to 1ST Floor, down hallway past gift shop, turn left, follow signage to Ambulatory Care.                                   |
| 3  | Breast Health Centre (Mammograms)          | Lobby entrance, proceed to elevator or stairs to 1ST Floor, down hallway past gift shop, turn left, follow signage to Breast Health Centre / Mammograms.                                       |
| 4  | Burns & Plastics Clinic                    | Lobby entrance, proceed to Admitting, proceed to elevator or stairs to 1ST Floor, down hallway past gift shop, turn left, follow signage to Burns & Plastics Clinic.                           |
| 5  | Cafeteria                                  | Lobby entrance, proceed to elevator or stairs to 1ST Floor, down hallway past gift shop, turn right, proceed down hallway to Cafeteria.  |
| 6  | Daily Grill / Subway                       | Lobby entrance, proceed to elevator or stairs to 1ST Floor, down hallway past gift shop, turn right, proceed down hallway to Cafeteria.  |
| 7  | Tim Hortons                                | Lobby entrance, proceed to elevator or stairs to 1ST Floor, down hallway past gift shop, turn right, proceed down hallway to Cafeteria.  |
| 8  | Cardiopulmonary                            | Lobby entrance, proceed to Admitting, then proceed to elevator or stairs to 1ST Floor, down hallway past gift shop, turn left, follow signage to Cardiopulmonary.                              |
| 9  | Cashiers                                   | Lobby entrance, proceed to elevator or stairs to 1ST Floor, down hallway past gift shop, turn right, proceed down hallway, follow signage to Cashier's Office.                                 |
| 10 | Community Care Access Centre (CCAC)        | Lobby entrance, proceed to Admitting, then proceed to elevator or stairs to 1ST Floor, down hallway past gift shop, turn left and follow signage to CCAC.                                      |
| 11 | Diabetic Clinic                            | Lobby entrance, proceed to Admitting, then proceed to elevator or stairs to 1ST Floor, down hallway past gift shop, turn left, follow signage to Diabetic Clinic.                              |
| 12 | Elevators (Patient/Visitors): Floors 1 - 8 | From escalator or elevator proceed down hallway past gift shop to Elevators on right.  |
| 13 | Gift Shop                                  | Lobby entrance, proceed to elevator or stairs to level one, down hallway, turn right to Gift Shop on left.   |
| 14 | Gynecology Clinic                          | Lobby entrance, proceed to Admitting, proceed to elevator or stairs to 1ST Floor, down hallway past gift shop, turn left, follow signage to Gynecology Clinic.                                 |
| 15 | Laboratory                                 | Lobby entrance, proceed to Admitting, proceed to elevator or stairs to 1ST Floor, down hallway past gift shop, turn left, follow signage to Laboratory.  |
| 16 | Multi-Faith Prayer Room                    | Lobby entrance, proceed to elevator or stairs to 1ST Floor, turn left at first hallway, follow signage to Multi-Faith Prayer Room on left.   |
| 17 | OB Clinic                                  | Lobby entrance, proceed to Admitting, then proceed to elevator or stairs to 1ST Floor, down hallway past gift shop, turn left, follow signage to OB Clinic.                                    |
| 18 | Patient Representative                     | Lobby entrance, proceed to elevator or stairs to 1ST Floor, down hallway past gift shop, past elevators, turn right down hallway, follow signage to Patient Representative on right.           |
| 19 | Pre-Admission Clinic                       | Lobby entrance, proceed to Admitting, then proceed to elevator or stairs to 1ST Floor, down hallway past gift shop, turn left, follow signage to Pre-Admission Clinic on right.                |
| 20 | Public Affairs & Communications            | Lobby entrance, proceed to elevator or stairs to 1ST Floor, down hallway past gift shop, turn right, follow signage to Public Affairs & Communications.  |
| 21 | Public Washrooms                           | Lobby entrance, proceed to elevator or stairs to 1ST Floor, down hallway, first hallway on left, turn left, follow signage to Public Washrooms on right.                                       |
| 21 | Public Washrooms                           | Lobby entrance, proceed to elevator or stairs to 1ST Floor, down hallway, second hallway on right, turn right, follow signage to Public Washrooms on right.                                    |
| 22 | Rapid Assessment Clinic                    | Lobby entrance, proceed to Admitting, then proceed to elevator or stairs to 1ST Floor, down hallway past gift shop, turn left, follow signage to Rapid Assessment Clinic on right.             |
| 23 | Student Registration                       | Lobby entrance, proceed to elevator or stairs to 1ST Floor, down hallway past gift shop, past elevator, turn left, follow signage to Student Registration.                                     |
| 24 | Telemedicine                               | Lobby entrance, proceed to elevator or stairs to 1ST Floor, down hallway past gift shop, past elevator, turn left, follow signage to Telemedicine on right.                                    |
| 25 | Volunteer Services                         | Lobby entrance, proceed to elevator or stairs to 1ST Floor, down hallway past gift shop, past elevator, turn left, follow signage to Volunteer Services.                                       |
| 26 | Windsor Regional Hospital Foundation       | Lobby entrance, proceed to elevator or stairs to 1ST Floor, down hallway past gift shop, turn right and proceed down hallway, follow signage to Windsor Regional Hospital Foundation on right. |