

OUELLETTE CAMPUS - PATIENT VISITOR WAYFINDING MAP & DIRECTORY

(FLOOR LEVEL 1)

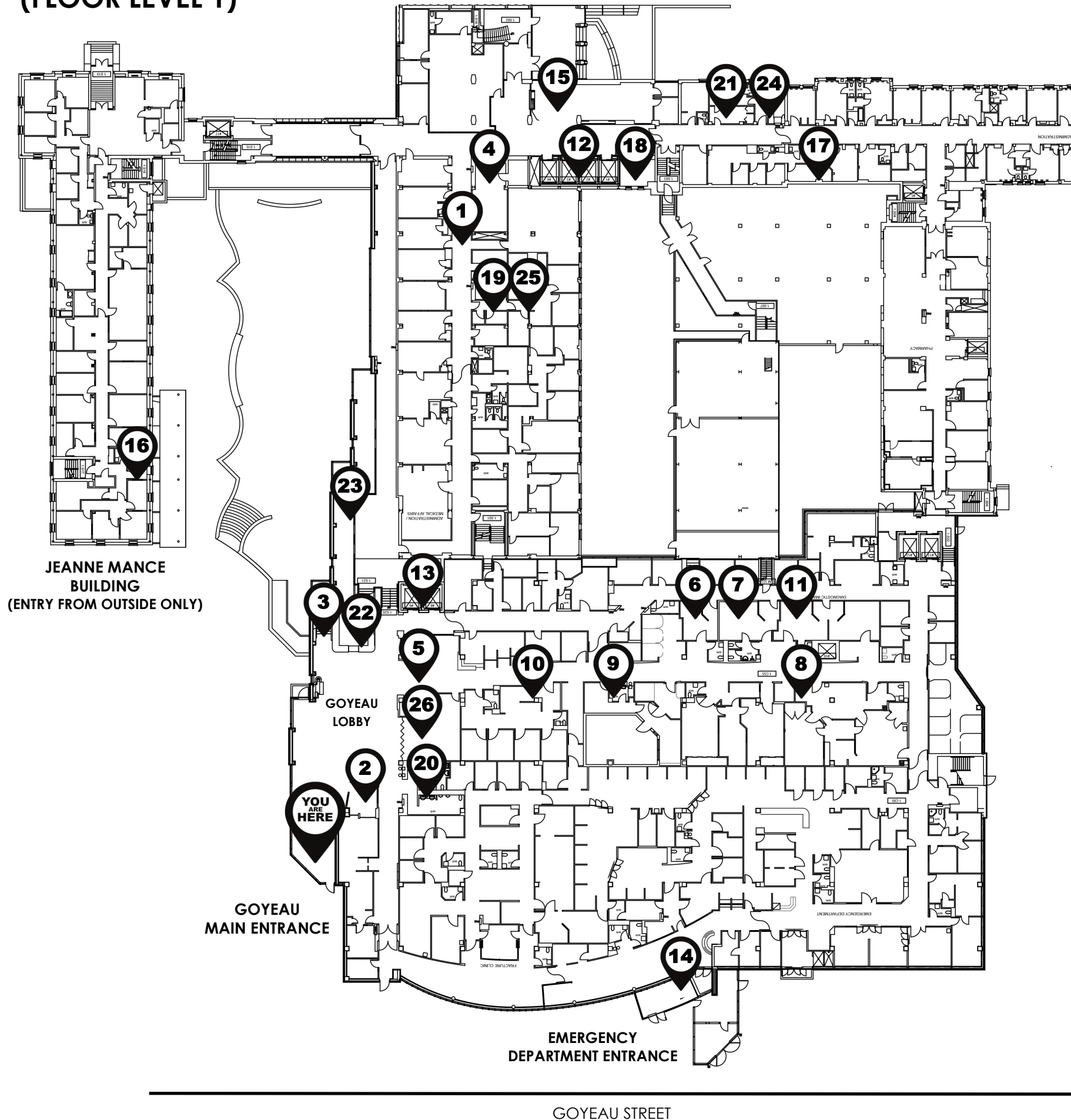

DIRECTORY (please see step-by-step directions on reverse)

- 1 - Administration
- 2 - Admitting
- 3 - Cafeteria / ATM / Vending Machines (stairs to ground level)
- 4 - Cashiers
- 5 - Diagnostic Imaging - Registration
- 5 - Diagnostic Imaging - Bone Scan
- 5 - Diagnostic Imaging - Ecocardiogram
- 5 - Diagnostic Imaging - EKG
- 5 - Diagnostic Imaging - EEG
- 6 - Diagnostic Imaging - CAT Scan
- 7 - Diagnostic Imaging - CT Scan
- 8 - Diagnostic Imaging - Interventional - Angio
- 9 - Diagnostic Imaging - MRI
- 10 - Diagnostic Imaging - Ultrasound
- 11 - Diagnostic Imaging - X-Ray
- 12 - Elevators (Main to Floors 2 - 8)
- 13 - Elevators (Patient Only)
- 14 - Emergency Department
- 15 - Gift Shop
- 16 - Jeanne Mance Building (Renal) - (Outside Entrance Only)
- 17 - Multi-Faith Prayer Room
- 18 - Patient Advocates Office
- 19 - Public Affairs
- 20 - Public Washroom
- 21 - Student Registration
- 22 - Tim Horton's
- 23 - Vendor Area
- 24 - Volunteer Services
- 25 - Windsor Regional Hospital Foundation
- 26 - We Care Pharmacy (Retail)

QUELLETTE CAMPUS - PATIENT VISITOR WAYFINDING - STEP-BY-STEP DIRECTIONS

(FLOOR LEVEL 1)

1	Administration	Proceed to elevator or stairs to 1ST Floor, turn right at first doorway, follow signage to respective office on right or left.
2	Admitting	Lobby entrance, turn right to Admitting
3	Cafeteria/ATM Vending Machines (stairs to ground level)	Lobby entrance, proceed to elevator or stairs to Basement Level, follow signage for Cafeteria / ATM / Vending Machines.
4	Cashiers	Lobby entrance, proceed to elevator or stairs to 1ST Floor, down hallway, turn right to cashiers
5	Diagnostic Imaging - Registration	Lobby entrance, turn right to Diagnostic Imaging registration
5	Diagnostic Imaging - Bone Scan	Lobby entrance, turn right to Diagnostic Imaging registration, then proceed to elevator or stairs to level one, down hallway, turn right to elevators, take elevator to 4th floor, turn right out of elevator to Nuclear Medicine.
5	Diagnostic Imaging - Ecocardiogram	Lobby entrance, turn right to Diagnostic Imaging registration, then proceed to elevator or stairs to level one, down hallway, turn right to elevators, take elevator to 4th floor, turn right out of elevator to Room #427
5	Diagnostic Imaging - EKG	Lobby entrance, turn right to Diagnostic Imaging registration, then proceed to elevator or stairs to level one, down hallway, turn right to elevators, take elevator to 4th floor, turn right out of elevator to Room #427
5	Diagnostic Imaging - EEG	Lobby entrance, turn right to Diagnostic Imaging registration, then proceed to elevator or stairs to level one, down hallway, turn right to elevators, take elevator to 8th floor, turn left out of elevator, then turn right to EEG.
6	Diagnostic Imaging - CAT Scan	Lobby entrance, turn right to Diagnostic Imaging registration
7	Diagnostic Imaging - CT Scan	Lobby entrance, turn right to Diagnostic Imaging registration
8	Diagnostic Imaging - Interventional Angio	Lobby entrance, turn right to Diagnostic Imaging registration
9	Diagnostic Imaging - MRI	Lobby entrance, turn right to Diagnostic Imaging registration
10	Diagnostic Imaging - Ultrasound	Lobby entrance, turn right to Diagnostic Imaging registration
11	Diagnostic Imaging - X-Ray	Lobby entrance, turn right to Diagnostic Imaging registration
12	Elevators (Main to Floors 2 - 8)	Lobby entrance, proceed to elevator or stairs to 1ST Floor, proceed down hallway, turn right and follow signage to Elevators on right.
13	Elevators (Patients Only)	Lobby entrance, proceed to the right to the Elevators (Patients)
14	Emergency Department	Lobby entrance, proceed back outside. Turn left to Emergency Room entrance.
15	Gift Shop	Lobby entrance, proceed to elevator or stairs to 1ST Floor, down hallway, turn right to Gift Shop on left.
16	Jeanne Mance Building (Renal)	Lobby entrance, proceed back outside, turn right around corner, proceed straight to Jean Mance Building entrance.
17	Multi-Faith Prayer Room	Lobby entrance, proceed to elevator or stairs to 1ST Floor, proceed down hallway, turn right and follow signage to Multi-Faith Prayer Room on right.
18	Patient Advocates Office	Lobby entrance, proceed to elevator or stairs to 1ST Floor, proceed down hallway, turn right and follow signage to Patient Advocates office on right.
19	Public Affairs	Lobby entrance, proceed to elevator or stairs to 1ST Floor, turn right at first doorway, follow signage to Public Affairs on right.
20	Public Washroom	Lobby entrance, proceed to elevator or stairs to 1ST Floor, proceed down hallway, turn right and follow signage to Public Washroom on left.
21	Student Registration	Lobby entrance, proceed to elevator or stairs to 1ST Floor, proceed down hallway, turn right and follow signage to Student Registration on left.
22	Tim Horton's	Lobby entrance, proceed forward to Tim Horton's
23	Vendor Area	Lobby entrance, proceed to elevator or stairs to 1ST Floor, vendor area on left after stairs
24	Volunteer Services	Lobby entrance, proceed to elevator or stairs to 1ST Floor, proceed down hallway, turn right and follow signage to Volunteer Services on left.
25	Windsor Regional Hospital Foundation	Lobby entrance, proceed to elevator or stairs to 1ST Floor, turn right at first doorway, follow signage to Public Affairs
26	We Care Pharmacy (Retail)	Lobby entrance, turn right to Pharmacy

OUELLETTE CAMPUS - PATIENT VISITOR WAYFINDING MAP & DIRECTORY (BASEMENT LEVEL)

DIRECTORY (please see step-by-step directions on reverse)

- 1 - ATM
- 2 - Cafeteria
- 3 - Cath Lab
- 4 - Elevators (Main to Floors 2 - 8)
- 5 - Elevators (Patients)
- 6 - Pre Admission Clinic
- 7 - Public Washroom
- 8 - Vending Machines

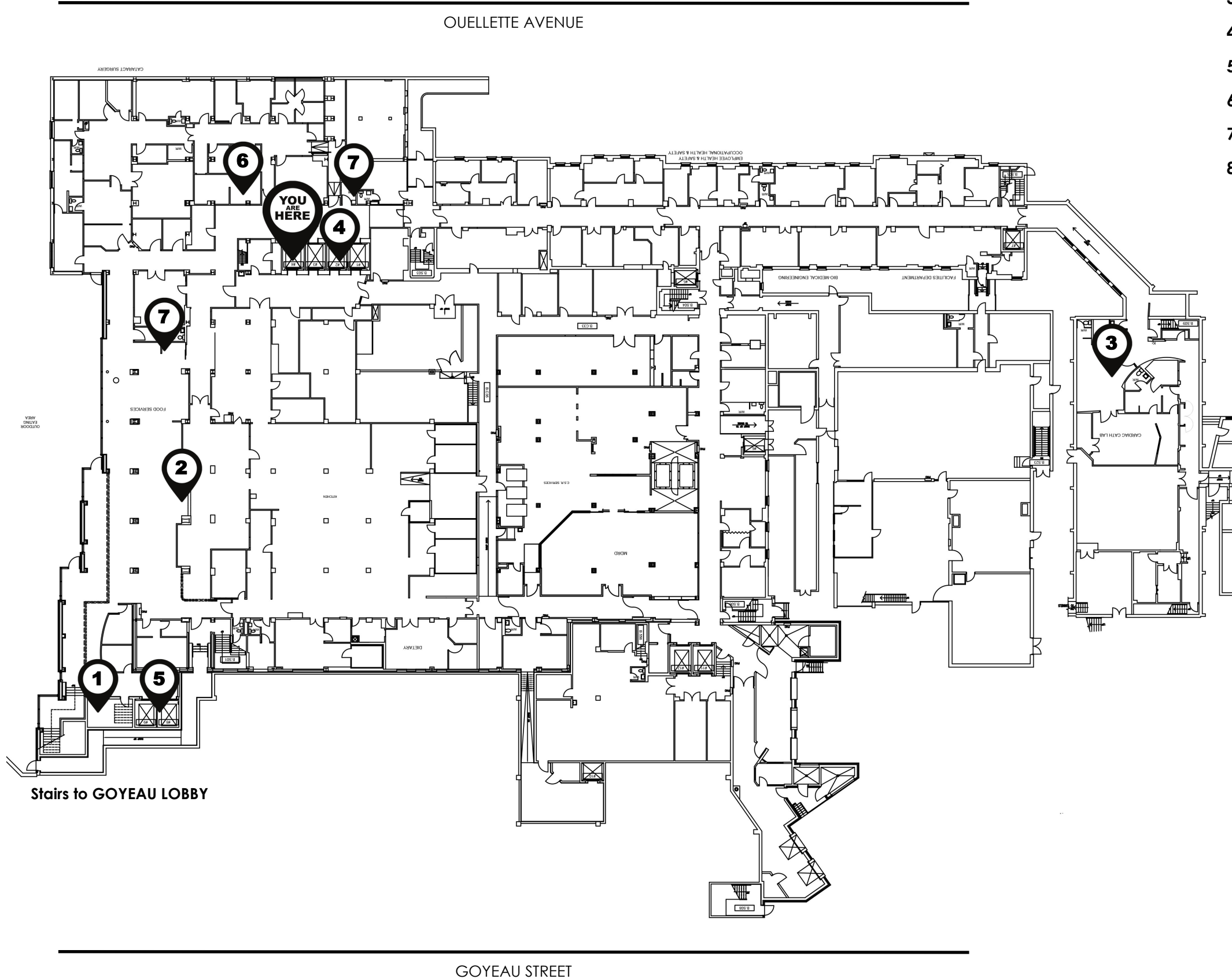

QUELLETTE CAMPUS - PATIENT VISITOR WAYFINDING - STEP-BY-STEP DIRECTIONS

(BASEMENT LEVEL)

1	ATM	Lobby entrance, proceed to elevator or stairs to 1ST Floor, down hallway, turn right to elevators, take elevator to Basement, turn left out of elevator, turn left through Cafeteria and follow signage to ATM.
2	Cafeteria	Lobby entrance, proceed to elevator or stairs to 1ST Floor, down hallway, turn right to elevators, take elevator to Basement, turn left out of elevator, turn left to Cafeteria and follow signage to Cafeteria.
3	Cath Lab (Angiogram, Angioplasty, Right Heart Studies)	Lobby entrance, turn right to Admitting, proceed to elevator or stairs to 1ST Floor, down hallway, turn right to elevators, take elevator to Basement, turn right out of elevator, follow red line to Cath lab.
4	Elevators (Main - Floors 1 - 8)	Lobby entrance, proceed to elevator or stairs to 1ST Floor, down hallway, turn right to elevators, take elevator to Basement.
5	Elevators (Patients)	Lobby entrance, proceed to elevator or stairs to 1ST Floor, down hallway, turn right to elevators, take elevator to Basement, turn left out of elevator, turn left through Cafeteria and follow signage to Elevators (Patients)
6	Pre-Admission Clinic	Lobby entrance, proceed to elevator or stairs to 1ST Floor, down hallway, turn right to elevators, take elevator to Basement, turn left out of elevator to Pre-Admission Clinic.
7	Public Washroom	Lobby entrance, proceed to elevator or stairs to 1ST Floor, down hallway, turn right to elevators, take elevator to Basement, turn right out of elevator to Public Washroom.
8	Vending Machines	Lobby entrance, proceed to elevator or stairs to 1ST Floor, down hallway, turn right to elevators, take elevator to Basement, turn left out of elevator, turn left to Cafeteria and follow signage to Vending Machines.